

FlushMaster[®] Cistern & Valve assembly

Model 43099 - FlushMaster Cistern and Valve assembly.

Model 41094 - FlushMaster Cistern Outlet valve

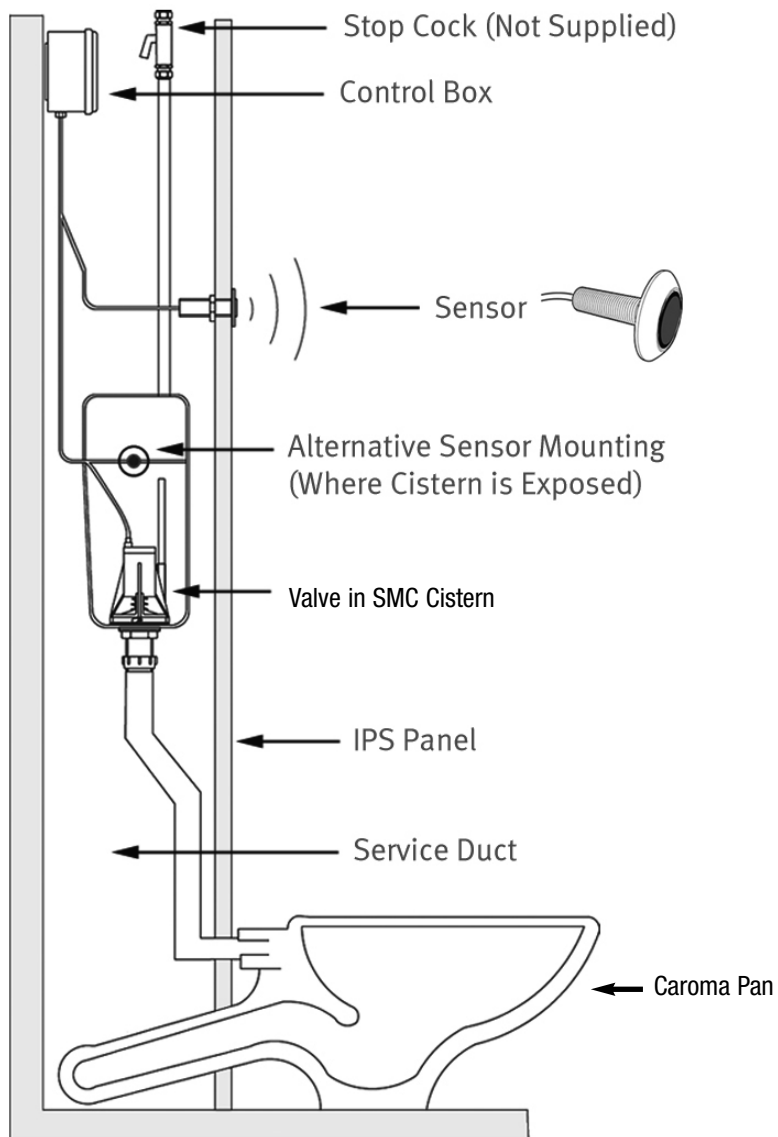

Contents

Product features	3
Installation	3
Installation continued	4
Setup	5
Operation	6
End of Life disposal	6
Kit Components	7
Warranty Information	8

Kit Components

Note: As various combinations of the FlushMaster Toilet Suite are possible, the components listed below are sold in two separate kit forms. (components are not sold separately)

Model 43099 - FlushMaster Cistern Outlet Valve, Fluidmaster Inlet Valve, SMC Cistern and Flush pipe (Pan not supplied)

Model 41094 - FlushMaster Cistern Outlet Valve

- Compatible SMC Cistern (see list on P3.)
- Fluidmaster Inlet Valve (see list on P3.)
- Compatible Caroma Pan (see list on P3.) - **NOTE:** Pan not supplied.
- FlushMaster Cistern Valve, Pt No 41094 (see List on P7.)
- Std. 50 mm Flushpipe 170 mm x 240 mm (Centres)

Read these Warnings first



- Read all the instructions before operating this appliance.
- This appliance is not intended for use by persons (including children) with reduced physical, sensory or mental capabilities, or lack of experience and knowledge, unless they have been given supervision or instruction concerning use of the appliance by a person responsible for their safety.
- Children should be supervised to ensure that they do not play with the appliance.
- If the plug or cord are damaged they must be replaced by a qualified technician. To avoid hazards, all installations must be carried out by a suitable qualified tradesperson.
- The Cold water supply to the Cistern inlet requires a minimum pressure of 70kPa and a Max pressure of 700kPa. If the pressure is likely to exceed 700kPa then install a 500kPa pressure limiting valve.
- Always disconnect power and water before making any adjustments.

Product Features

The FlushMaster Cistern and Valve assembly is an electronically controlled system, designed as a versatile stand alone unit with dual flush capabilities to suit a variety of different installations. The FlushMaster assembly can be set to operate for up to 9 seconds (full flush) with adjustments made in 1 second increments. When correctly installed may deliver a 4.5 / 3 Litre flush (setting 3) or 6 / 3 Litre flush (setting 4).

The electronic system uses two, no-touch, infrared sensors, which have been modulated to activate when the user's hand is within 50mm of the sensor. The sensors are remotely mounted in a convenient position to allow for easy operational access. The no-touch sensors promote good hygienic practices and with no moving parts, require no maintenance and are vandal resistant.

For multiple installations a maximum of 4 control boxes may be fitted to a single 10amp GPO (see Fig.3)

Compatible cisterns:

The following SMC stainless steel products are compatible with the FlushMaster Cistern Outlet Valve.

Tank Dimensions: 400 W x 325 H x 170 D

Material : 304 Stainless Steel

Inlet Valve: Caroma Fluidmaster 400UK / 707UK

SMC Cistern
SCC-1-PC
SCC-1-PB
SCC-3
SCC-1-DF
SCC-1-DFVR

Compatible Pans:

- Caroma Trident Smartflush; Concorde; Newport & Leda 2000
- Raymor Mini Smartflush
- Posh Smartflush

Requirements:

- The control box and sensors must be mounted within 2 metres of the Cistern valve
- A 220 - 240V 50Hz 10 amp General Purpose Outlet must be supplied within 1 metre of the control box.
- All plumbing must comply with AS/NZS 3500.
- Std. 50 mm Flushpipe 170 mm x 240 mm (Centres)
- Minimum Cistern inlet water pressure 70kPa and Maximum 700kPa.
- Toilet Pan must be installed in accordance with the manufacturer's instructions.

Retrofit Installation

SMC Stainless Cisterns are fitted with Caroma Fluidmaster K4 or K5 outlet valves. Once the cisterns have been isolated from the mains and drained, follow the instructions below to fit the new FlushMaster Cistern valve: Ref. Fig 2

- Remove the top cover and place to one side, for re-use. Note model SCC-1-DFVR is fitted with tamper proof screws and will require a special tool to remove the lid. (Contact the manufacturer for details.)
- Disconnect and remove the push button or chain pull actuator.
- Disconnect and remove the flush pipe from the cistern outlet. Discard any sealing washers.
- Disconnect and remove the K4 or K5 outlet valve.
- Clean the inside of the cistern, ensuring the area around the seal is free of any debris or sediment.
- Fit the isolator sealing washer, then apply some sealing tape to the valve threads.
- Install the FlushMaster valve assembly into the cistern and secure with the backnut.
- Continue with the New Installation instructions Page 4

New Installation

Warning: The overflow pipe must be measured and cut to length before fitting to the valve. The overflow pipe must be installed with a minimum air separation distance of 20 mm below the Inlet valve delivery orifice, in accordance with the backflow requirements of AS/NZS 3500.1

- Fit the overflow pipe to the outlet valve housing.
- Refit the flush pipe using new sealing washers.
- Blank off any of the push button holes. (these may be used for valve cable access).
- Route and secure the valve cable to a convenient position for the control box. i.e. within 2 metres
- Position the sensors and controller (see fig.4), then connect the cables as indicated.

Note: Turn off the power before making any adjustment or re-adjustment settings.

- Setting No.0 is used as a test setting and will give a full flush for aprox 2.5 secs. (to fill the toilet trap) this setting also checks the system to ensure all electrical connections are functioning correctly.
- Settings Numbered from 1-9 will give progressively increasing flushes up to aprox 9 litres (Full flush).
- Fill and test the system. Adjust the settings to match the rating on the Pan. Setting No.3 will give a 4.5 / 3 L flush and setting No.4 will give a 6 / 3 L flush.
- Ensure the Maximum water level is below the overflow pipe, otherwise the cistern will fill and empty at the same time. Adjust the float setting accordingly.
- In order to reduce the operational noise of the outlet valve, the minimum water level should not fall below the level indicated in fig.1
- Check for leaks and secure the system by replacing the cistern lid.

Fig.1

NOTE: Remember to turn off the water and electrical supplies before making adjustments to the water or control system.

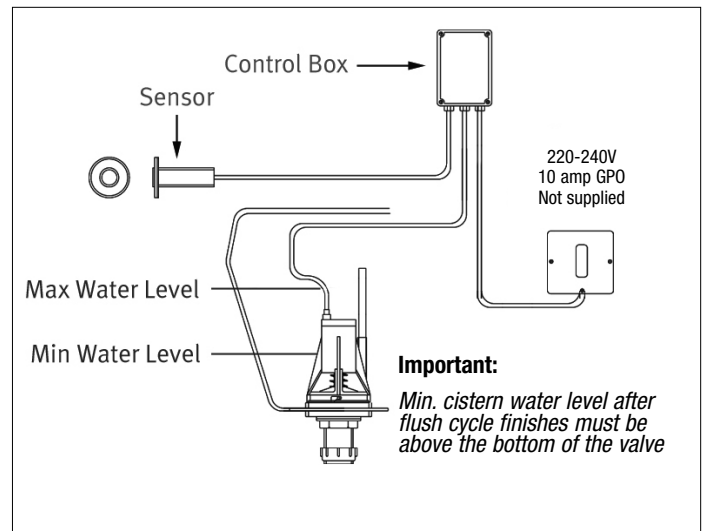
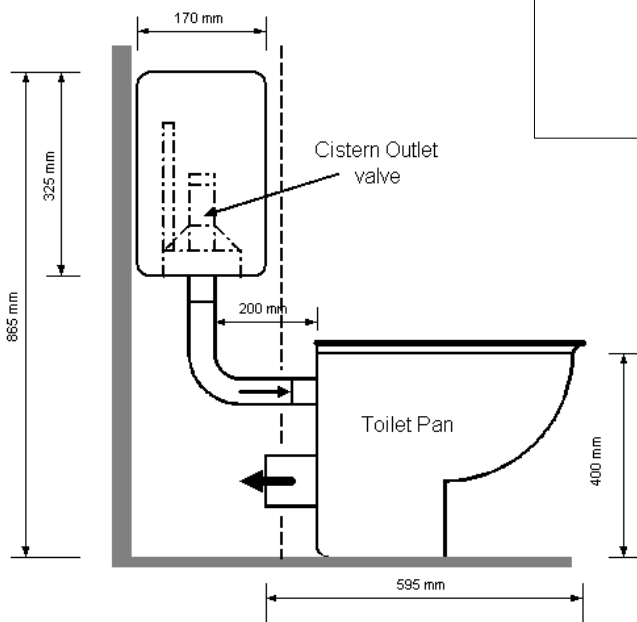
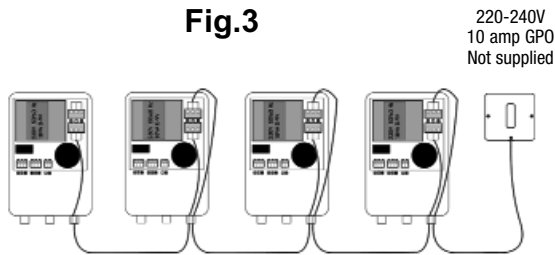

Fig.2

Recommended installation for SMC cistern and Caroma toilet pan.

Multiple Installation:



A maximum of 4 control boxes may be fitted to a single 10 amp GPO.

On multiple installations an extra cable gland will need to be fitted (drill the box to suit). The 1.5 meter length of 0.75 mm 3 core flex will need trimming (after plug removal) and must not be extended.

Upon completion ensure all cable glands are tight.

Typical single installation:

Fig.4

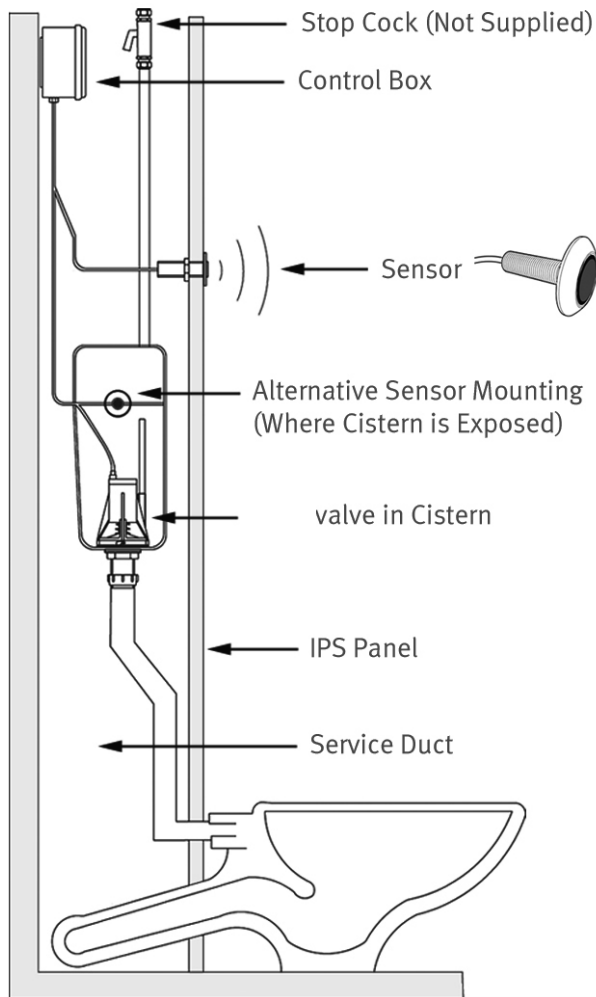

Sensor fitting:

Care must be taken to ensure ease of use and that general WC cubical occupancy cannot accidentally trigger a flush.

The sensors needs to be fitted on a vertical surface less than 2 meters away from the control box through a 17-25mm pre-drilled hole, then secured with the nut, washer, bezel and backplate provided.

Connect the sensor cable to the control box (fig.5). Please check the cable is clean and dry before connecting onto the PCB.

Note: Do not attempt to modify or adjust the length of the sensor cable.

Outlet Valve electrical connection:

The valve cable should be trimmed to length and connected to the control box (Fig.5). Blue wire to Blue terminal and Brown wire to Brown terminal. Please check the cable is clean and dry before connecting to the PCB

Operation

Control Box PCB detail:

Fig.5

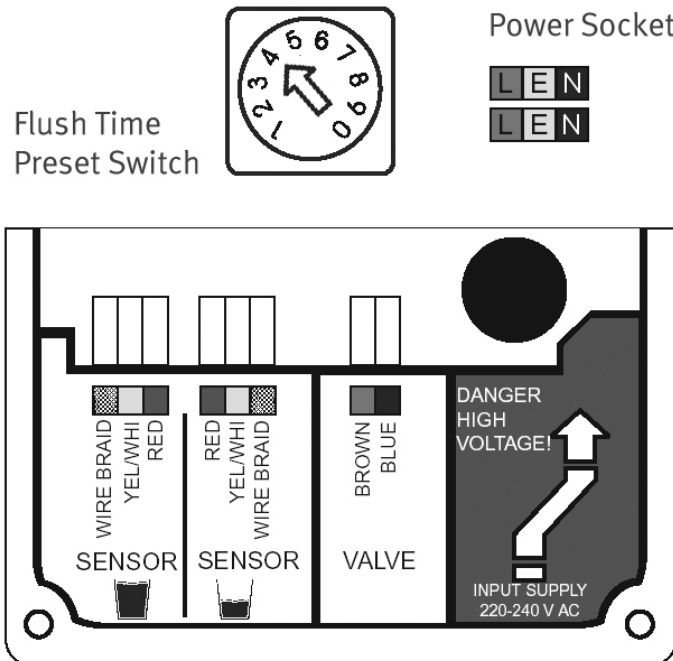

When the control box is initially connected both LED's will illuminate. The green LED indicates power-up and the red LED shows the system status.

When power is applied the red LED will flash a number of times. This will equal the setting on the flush time preset switch (1-9). It will remain illuminated for 30 sec and while in this mode the valve cannot be operated.

After each flush the red LED will again illuminate for 30 sec. to indicate the system is resetting itself for the next flush cycle.

To alter the flush duration, rotate the flush time preset switch to the desired position. The preset numbers (1-9) approximate to a full flush time in seconds. The half flush timing is automatic and can not be adjusted.

Note: Never adjust the flush time preset without disconnecting the power first

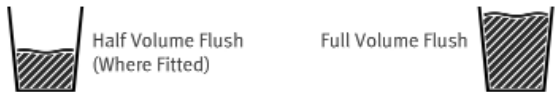

The sensor can be installed in either of two positions, or you can fit two sensors allowing the user to benefit from full or half flush volumes.

End of life disposal



The use of this crossed out wheeled bin logo indicates that this product needs to be disposed of separately to any other household waste.

Within each of the European Union member countries, provisions have been made for the collection and recycling of unwanted electrical and electronic equipment. Outside of the EU it will be necessary to dispose of this product at your local community waste collection or recycling centre. In order to help preserve our environment we ask that you dispose of this product correctly. Please contact your local city council for collection centre details

FlushMaster Cistern Valve Components

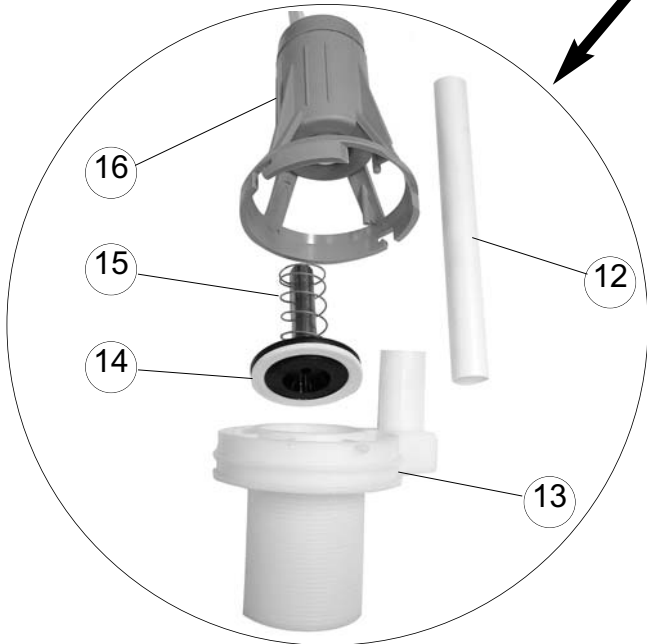
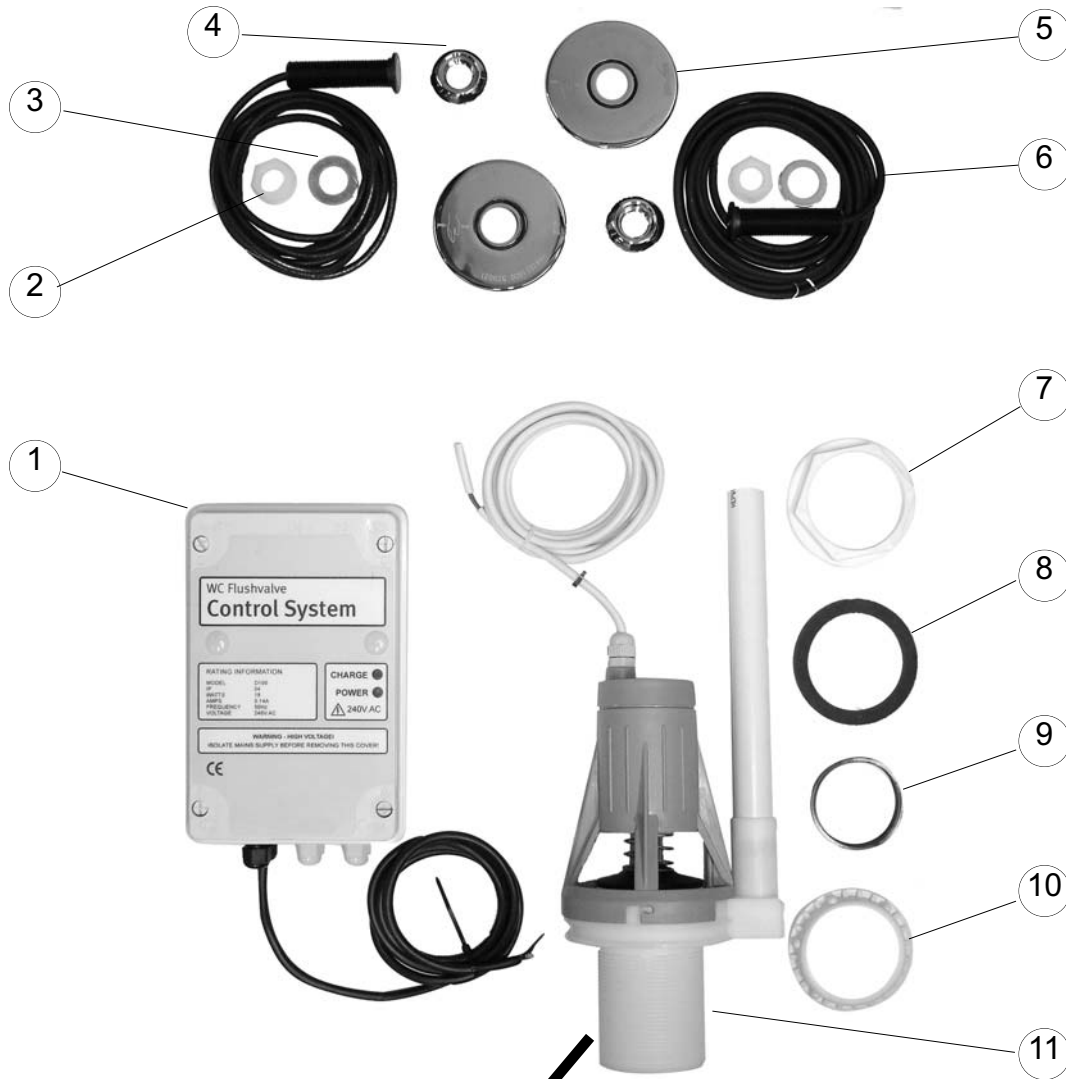

ITEM	DESCRIPTION
1	Control Box
2	Sensor backnut
3	Sensor washer
4	Sensor Bezel
5	Sensor backplate
6	Sensor & cable
7	Backnut
8	Isolator seal
9	Flushpipe seal
10	Flushpipe seal nut
11	Valve assembly
12	Overflow pipe
13	Valve base
14	Piston
15	Spring
16	Valve upper body

Warranty

Certain warranties may be implied by law into your contract with Zip. The warranty provided below is additional to these implied warranties and nothing set out below shall limit your statutory rights or rights at law.

Zip Heaters (Aust.) Pty. Ltd warrants that, should any part fail within 12 calendar months of installation, that part will be repaired or replaced free of charge by Zip or its Distributor or Service Provider, except as set out below, provided the appliance is installed and used strictly in accordance with the instructions supplied, and that failure is not due to accident, misuse, abuse, unsuitable water conditions, or to any alteration, modification or repair by any party not expressly nominated by Zip.

No costs are payable by the customer other than any mileage or travelling-time charges incurred by a Zip Service Provider or the cost of removal, cartage and re-installation of any component of the appliance if it needs to be returned for repair to Zip or its Distributor.

This warranty does not cover damage resulting from non-operation of the appliance, the use of non authorised parts or consequential damage to any other goods, furnishings or property.

No warranty applies to the life of any filtration cartridge installed with the appliance as cartridge life may vary according to water quality and the rate of water consumption.

Zip does not exclude, restrict or modify any liability that cannot be excluded, restricted or modified or which cannot, except to a limited extent, be excluded, restricted or modified as between the owner or user and Zip under the laws applicable.

Furthermore, this warranty does not displace any statutory warranty, but, to the extent to which Zip is entitled to do so, the liability of Zip under any statutory warranty will be limited at Zip's option to the replacement of the appliance or supply of equivalent appliance, the payment of the cost of replacing the appliance or acquiring an equivalent appliance, or the payment of the cost of having the appliance repaired or the repair of the appliance.

Registering Your Purchase

Registering your Zip installation on the Zip website may help to establish date of installation should it become necessary to service the appliance under terms of the Zip warranty. To register your installation go to www.zipheaters.com and look under the heading "Warranty".

Head Office

Zip Heaters (Aust) Pty. Ltd.
ABN 46 000 578 727
67 Allingham Street
Condell Park NSW 2200
Postal: Locked Bag 80
Bankstown 1885 Australia

Website: www.zipheaters.com
Facsimile (02) 9796 3858
Telephone (02) 9796 3100
Free Call 1 800 638 633

As Zip policy is one of continuous product improvement, changes to specifications may be made without prior notice. Images in this booklet have been modified and may not be true representations of the finished goods.

